

CM SNK EF C

MATRIX Tap Range

Matrix Easyfit Sink Mixer
Chrome



Specification

Product Type:	Kitchen Taps
Main Construction Material:	Brass
Mount Type:	Deck Mounted
Handle Type:	Lever
Connection Inlet:	1/2" BSP Flexible Tails
Connection Outlet:	
Number of Tap Holes:	1
Valve/Cartridge Type:	1/2" Compression Valves
Plumbing System Requirements:	All, Preferably Balanced
Working Pressure Range:	Min 0.3 Bar, Max 5.0 Bar
Maximum Hot Water Temperature: °C	65
Maximum Static Pressure: (bar)	10
Flow Type:	Single Flow
Isolation Included:	Yes

Features:

- Metal fixing nut for added durability
- Easyfit base included
- Flexible tails included

Product Certifications:



Dimensions (measurements in mm)

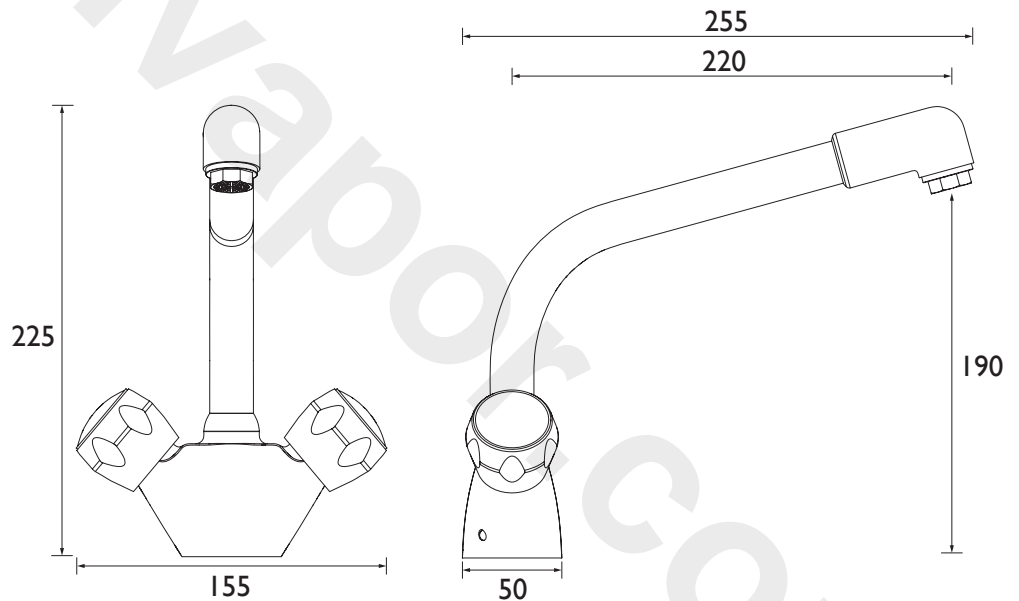

For more products, visit our website:
<http://www.bristan.com>



Flow Rates (l/min)

System Pressure (bar)	0.2	0.5	1	2	3	5
CM SNK EF C	15.8	20.4	28.8	40.7	49.9	64.4

TECHNICAL DATA SHEET



BRISTAN

TAPS & SHOWERS

D2